

Hambden Township Ditch Enclosure Application Process

The Hambden Township Road Department has established a procedure where a property owner may request that an open ditch be enclosed with a pipe(s).

An integral part of our highway system is roadside drainage. Roadside drainage systems not only collect surface water and direct it away from the road surface, it also drains the sub-base of the roadway. Drainage of the sub-base is vital to the strength and stability of the road itself and provides longevity of the surface. Please complete the application and submit it to the Township. Once we have received the application it will be reviewed and the roadside ditch and general surrounding drainage will be inspected to determine the requirements to enclose an open ditch. The Road Department will communicate the design and specifications for proper installation to you after inspection and review. The Road Department reserves the right to deny an application if suitable results for an enclosure cannot be achieved.

ALL costs of a ditch enclosure are to be borne by the property owner. It is the responsibility of the owner to install the enclosure per the specifications provided by the township.

ALL future maintenance of a ditch enclosure shall be borne by the property owner. If the enclosure should ever fail the township reserves the right to remove the enclosure pipe and restore an open ditch.

You can expect to hear back within four (4) weeks of submittal with approval with specifications and design or denial.

If you have any concerns or questions please contact the Road Department Superintendent at:

440-286-4364

Or

Roaddept@hambdentownship.com

Hambden Township Road Dept
13887 G.A.R. Hwy
Chardon, OH 44024

Date ___/___/___

Owner Name: _____

Property Address: _____

Phone Number: _____

E-mail Address: _____

Location of proposed enclosure: _____

Enclosure to be on the (check applicable) North ___ South ___ East ___ West ___ side of the road.

_____ miles (circle one) North South East West of Twp/Co Rd/State Hwy _____ intersection.

Show in sketch below where the proposed enclosure will be in relation to the property line/driveway.

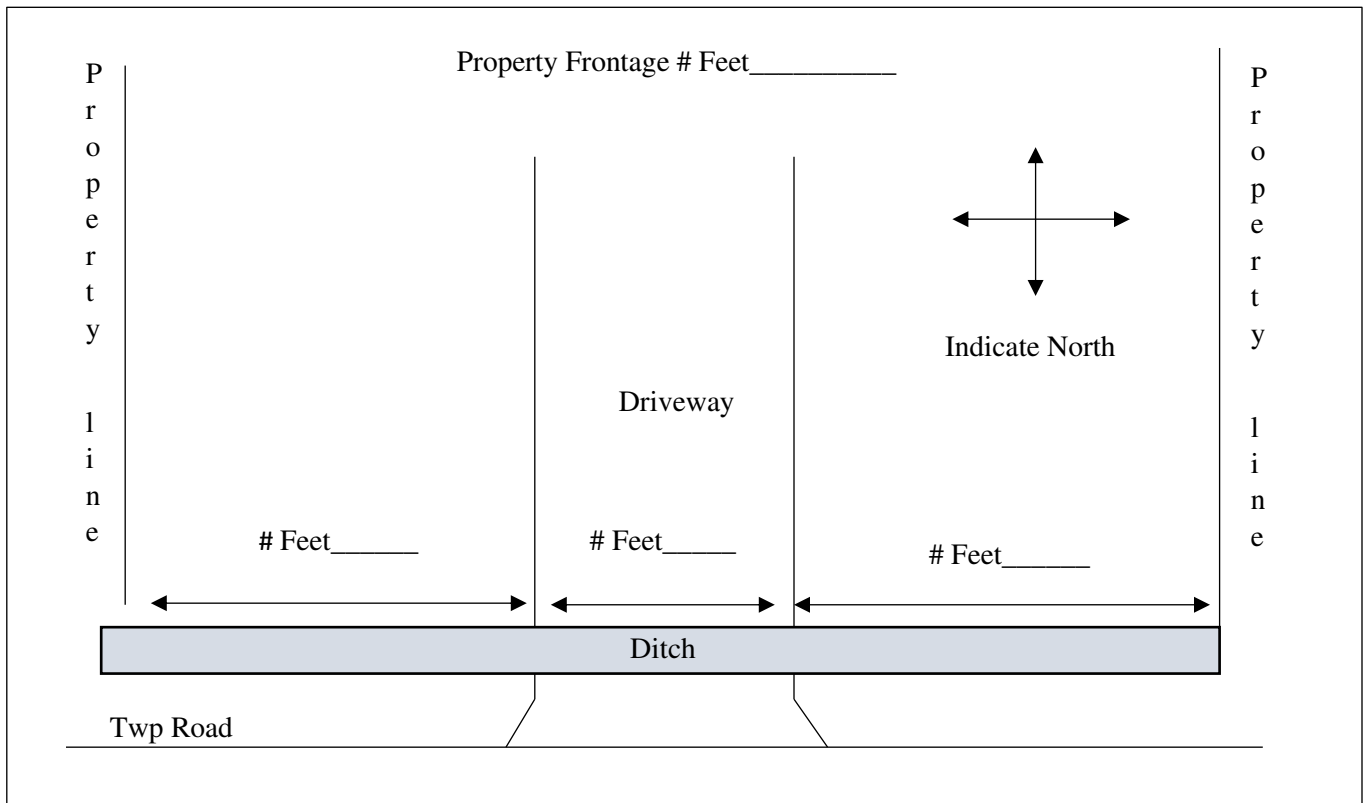

RESPONSIBILITY:

- 1) If this permit is granted I/we agree to comply with all the conditions, restrictions, and regulations of Hambden Township in such cases made and required.
- 2) If this permit is granted I/we agree to construct that part of the enclosure within the road right-of-way at an approved profile as shown on the Hambden Township Ditch Enclosure Sheet. I/we also agree to refrain from constructing curbs or headwalls in the shoulder that could create hazards or hamper maintenance operations such as snow plowing, roadside mowing, or berm maintenance.
- 3) I/we agree that when, in the course of construction of the ditch enclosure, work persons or vehicles are required to be on the pavement or shoulder and that I/we will provide and maintain lights, signs, barricades, traffic control persons for the protection of the public and employees/contractor in accordance with the Ohio Manual of Uniform Traffic Control Devices for Streets and Highways, Part 7 (Construction and Maintenance Operations).
- 4) I/we also agree to accept maintenance responsibility for the ditch enclosure. If the enclosure is not maintained to properly handle roadside and sub-surface drainage, the Hambden Township Road Department reserves the right to remove the enclosure and restore an open ditch.

By signing below you agree to all conditions above.

Owner/Developer _____ Date ___/___/___

TO BE COMPLETED BY THE HAMB DEN TOWNSHIP ROAD DEPARTMENT SUPERINTENDENT

Township Road Name _____ Section _____

Width of R.o.W _____ Feet Width of Berm _____ Feet

Proposed Ditch Enclosure to be along the(circle) North South East West side of roadway.

Diameter of Pipe: _____ inches

Pipe Type _____

Direction of Flow – existing ditch (circle) North South East West

Depth of Ditch: _____ inches below the elevation edge of the pavement.

Additional Requirements to be imposed _____

Attach Ditch Enclosure Drawing # _____

Site Inspected by _____ Date ___/___/___

Hambden Township Road Superintendent _____ Date ___/___/___